

## TITAN Valve Wheel Wrenches



TITAN VALVE WHEEL WRENCHES are used to provide leverage on hand operated valve wheels. This series of wrenches permits a smooth snap "hammer-action" to make opening and closing stubborn valves easy. Each wrench will fit a variety of sizes and shapes of valve wheels. The special shaped opening in the wrench reduces the chance of slippage when working in overhead or crowded positions.

TITAN Valve Wheel Wrench				
ITEM	PATTERN	CAST OR FORGED	OVERALL LENGTH (approx.)	WEIGHT
<b>STEEL</b>				
VW0	Double-end	Forged	8"	0,40
VW0CPTC*	Double-end	Forged	8"	0,34
VW10	Double-end	Forged	10"	0,8
VW1	Single-end	Forged	15"	1,1
VW12	Double-end	Forged	18"	1,93
VW2	Single-end	Forged	22"	2,15
VW3	Single-end	Forged	27"	5,16
VW3L	Single-end	Cast	48"	6,9
VW4	Single-end	Forged	48"	7,4
VW5	Single-end	Cast	48"	7,14
VW6	Single-end	Cast	48"	7,14
<b>BRONZE</b>				
VW0BR	Double-end	Cast	8"	0,43
VW10BR	Double-end	Cast	10"	0,85
VW1BR	Single-end	Cast	15"	1,1
VW12BR	Single-end	Cast	15-1/2"	1,3
VW2BR	Single-end	Cast	22"	2,5
VW3BR	Single-end	Cast	30"	4,14
<b>ALUMINUM</b>				
VW0AL	Double-end	Cast	8"	0,14
VW10AL	Double-end	Cast	10"	4,76

## TITAN Valve Wheel Wrench

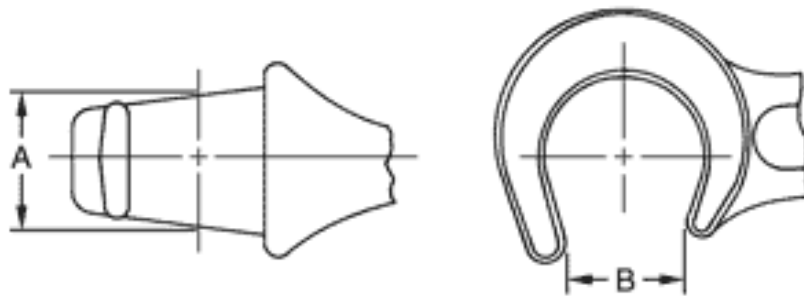

DIMENSIONS TITAN Valve Wheel Wrench				
ITEM	SMALL	LARGE	SMALL	LARGE
<b>SIZE</b>				
0	11/16"	7/8"	1/2"	21/32"
0CPTC	7/16"	7/16"	1/2"	21/32"
10	7/8"	1-3/16"	11/16"	1"
1	1-3/16"		1"	
12	1-1/2"	1-7/8"	1"	1-5/16"
12BR	1-1/2"		1-3/8"	
2	1-7/8"		1-5/16"	
3	2-1/2"		2"	
3L	2-3/4"		2"	
4	2-11/16"		2-1/4"	
5	2-3/4"		2-1/2"	
6	2-7/8"		2-3/4"	